



# HYDRAULIC BREAKERS

## DX SERIES

### Floating power cell & bolt free enclosed housing

- Prevent carrier boom & arm fatigue failure
- No metal to metal contact
- Floating and fully enclosed power cell
- Extend breaker & carrier service life
- Low noise
- Suitable for all applications, particularly including trenching, quarry & mining

### Lubrication

- Various lubrication systems available
  - Hydraulic auto lube system
  - Mechanical auto lube system
  - Manual lube system

### Advanced internal valve system

- Built in cylinder
- Energy efficiency
- Oil leakage free
- Thicker flesh cylinder block
- Least maintenance & repair requirement

### Work mode selector

- Optimize power and speed upon application requirements
- Enable maximum productivity in all applications from light to severe duty material breaking
- Available for Danda 70DX & above

### Easy start

- Fast response time to breaker activation signal
- Significantly increase productivity at light or interior demolition applications
- Suitable for skid steer loader breaker applications
- Available for Danda 17V, 40V & 60V

### Large capacity accumulator & diaphragm

- Proactively prevent carrier hydraulic part fatigue failure
- Accelerate striking performance
- Prevent cavitation
- Increase seal & diaphragm service life
- Available for Danda 40V & above (excluding skid steer loader breaker)

### Bottom plate

- Anti-abrasive high tensile raw material
- Fully enclosed lower bush & front head block
- Minimize debris & dust entering percussion chamber
- Increase service life of housing, tool, lower bush & front head

### Working tool

- Heat treatment of core as well as surface
- Optimum balance for longer wear life and crack prevention
- Variety of conventional and special tool types

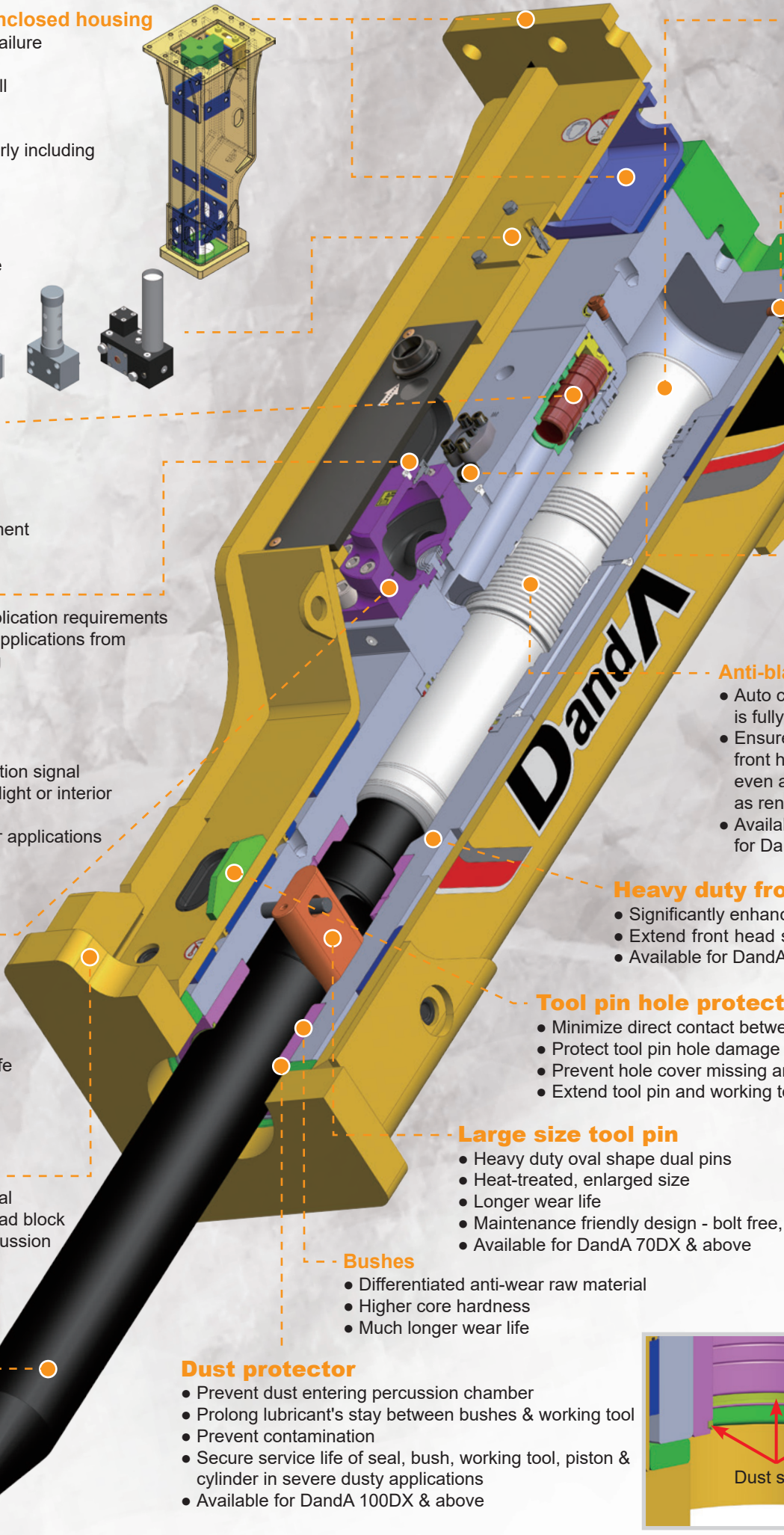
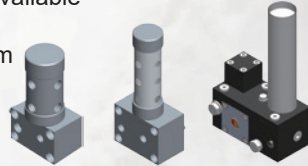
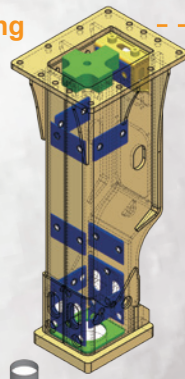

### Anti-bl

- Auto c
- is fully
- Ensure
- front h
- even a
- as ren
- Availa
- for Da

### Heavy duty fro

- Significantly enhance
- Extend front head s
- Available for DandaA

### Tool pin hole protect

- Minimize direct contact between
- Protect tool pin hole damage
- Prevent hole cover missing a
- Extend tool pin and working to

### Large size tool pin

- Heavy duty oval shape dual pins
- Heat-treated, enlarged size
- Longer wear life
- Maintenance friendly design - bolt free,
- Available for Danda 70DX & above

### Bushes

- Differentiated anti-wear raw material
- Higher core hardness
- Much longer wear life

### Dust protector

- Prevent dust entering percussion chamber
- Prolong lubricant's stay between bushes & working tool
- Prevent contamination
- Secure service life of seal, bush, working tool, piston & cylinder in severe dusty applications
- Available for Danda 100DX & above

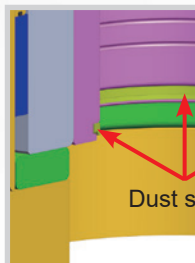

## - Large capacity gas chamber & optimum piston size

- Hybrid energy efficiency design
- Higher impact power delivery
- Least oil flow consumption
- Durable piston design - larger surface contacting working tool
- Dampening repercussion vibration force
- Preventing carrier structure fatigue failure

## External gas charging

- Gas charging from external housing
- No need of housing or lubrication device disassembly
- Least maintenance time
- Designed for maintenance at the job site

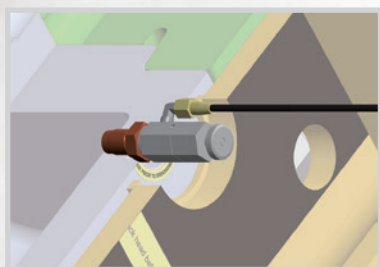

## Air supply channel

- Built in air supply channel
- Prepared for underwater, tunneling & severe dusty applications

## Blank firing system (auto stop)

Turn off hydraulic power when the material is broken  
 Prolong service life of tool pin, working tool, head, piston, through bolt and diaphragm  
 Suitable for the frequent dry firing applications such as  
 initial, secondary rock breaking & scaling  
 Suitable for Danda 80DX & above, on demand  
 Danda 60V & 70DX



## Front head block

Increased front head duty level  
 Prolong service life  
 Suitable for Danda 100DX & above

Prevent debris from entering  
 Prevent debris/dust entering  
 Prolong tool wear life

Seal rubber plugged holes



## Benefits

- Higher impact power
- Higher productivity
- Market proven quality, durability & life time
- Easy maintenance & repair
- Low fatigue stress on carrier machines
- Reasonable owning cost
- Low operating cost
- Higher return on investment

## Working tool

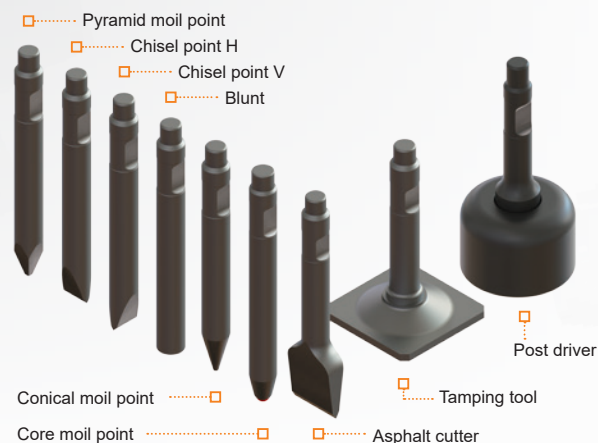

Conventional working tool	Applicable type					Remark
	Primary breaking	Secondary breaking	Hard rock removal	Soft material & rock material	Demolition	
Chisel point V	○		○	●	●	All models
Chisel point H	○		○	●	●	All models
Pyramid moil point	●		○	●	●	All models
Conical moil point	●		○	●	●	All models
Blunt		●	●		○	All models

Special working tool	Applicable type				Remark
	Asphalt removal	Compacting	Post driving	Severe duty rock removal	
Asphalt cutter	●				Danda 6V ~ Danda 80DX
Tamping tool		●			Danda 6V ~ Danda 80DX
Post driver			●		Danda 6V ~ Danda 80DX
Core moil point				●	Danda 8V & above

● Highly recommended ○ Selectively applicable

# Comprehensive product line up

- 23 breaker models that cover the entire CE industry carrier range from 0.5 to 140 ton
- 1 model variant exclusively designed for dedicated light material breaking champion with 18 to 22 ton carrier
- 4 model variants exclusively designed for skid steer loader
- On-demand housing variants for optimum traveling position with backhoe loader
- Suitable from light and medium to hard & severe duty rock breaking applications

## Compact breaker

			DandA 6V	DandA 7V	DandA 8V	DandA 17V	DandA 40V	DandA 60V	DandA 70DX	DandA 80DX
Operating weight	kg		80	105	141	184	325	412	518	600
	lb		176	232	311	406	717	908	1,143	1,323
Required oil flow	l/min		15~21	12~25	13~30	20~60	29~60	34~68	38~85	42~85
	g/min		3.96~5.55	3.17~6.60	3.43~7.93	5.28~15.85	7.66~15.85	8.98~17.96	10.04~22.45	11.10~22.45
Operating pressure	kg/cm <sup>2</sup>		60~130	90~120	90~120	90~120	110~165	120~165	140~170	140~170
	psi		853~1,849	1,280~1,707	1,280~1,707	1,280~1,707	1,565~2,347	1,707~2,347	1,991~2,418	1,991~2,418
Number of blow	Power mode	bpm								
	Speed mode	bpm	800~1,200	800~1,400	550~1,000	600~1,500	380~1,000	380~900	400~800	350~700
Relief valve setting pressure	kg/cm <sup>2</sup>		175	175	175	175	175	175	175	175
	psi		2,489	2,489	2,489	2,489	2,489	2,489	2,489	2,489
Tool diameter	mm		40	40	45	57	70	75	80	90
	inch		1.57	1.57	1.77	2.24	2.76	2.95	3.15	3.54
Suitable carrier	ton		0.5~2.0	0.5~2.0	0.8~2.5	1.5~4.0	3.0~6.5	4.5~8.0	4.5~8.0	6.0~10.0
	lbs		1,102~4,409	1,102~4,409	1,764~5,512	3,307~8,818	6,614~14,330	9,921~17,637	9,921~17,637	13,228~22,046

\* Above numbers are subject to change without prior notice, only provided for references in combination with carrier hydraulic performance.

\* Above operating weight includes 1 working tool, 2 hoses and 1 mounting bracket with 2 pins that are supplied by the manufacturer only.

## Medium breaker

			DandA 100DX	DandA 130DX	DandA 150DX	DandA 180DX	DandA 200DX	DandA 220DX	DandA 250DX	DandA 300DX
Operating weight	kg		875	1,012	1,231	1,448	1,577	1,845	2,021	2,507
	lb		1,929	2,231	2,714	3,192	3,477	4,068	4,456	5,527
Required oil flow	l/min		63~102	68~119	85~127	85~131	102~132	119~161	127~178	153~204
	g/min		16.64~26.95	17.96~31.44	22.45~33.55	22.45~34.61	26.95~34.87	31.44~42.53	33.55~47.02	40.42~53.89
Operating pressure	kg/cm <sup>2</sup>		140~180	140~190	140~190	150~190	160~190	160~190	160~190	160~190
	psi		1,991~2,560	1,991~2,702	1,991~2,702	2,134~2,702	2,276~2,702	2,276~2,702	2,276~2,702	2,276~2,702
Number of blow	Power mode	bpm	350~600	350~550	320~550	320~500	320~480	340~450	270~400	250~380
	Speed mode	bpm	600~900	600~900	400~700	400~650	400~600	420~550	330~500	300~450
Relief valve setting pressure	kg/cm <sup>2</sup>		210	210	210	210	210	210	210	210
	psi		2,987	2,987	2,987	2,987	2,987	2,987	2,987	2,987
Tool diameter	mm		95	105	115	125	135	135	145	150
	inch		3.74	4.13	4.53	4.92	5.31	5.31	5.71	5.91
Suitable carrier	ton		8.0~12.5	10~15	12~18	16~22	18~24	20~26	24~30	25~36
	lbs		17,637~27,558	22,046~33,069	26,455~39,683	35,274~48,502	39,683~52,911	44,092~57,320	52,911~66,139	55,116~79,366

\* Above numbers are subject to change without prior notice, only provided for references in combination with carrier hydraulic performance.

\* Above operating weight includes 1 working tool, 2 hoses and 1 mounting bracket with 2 pins that are supplied by the manufacturer only.

## Large breaker

			DandA 360DX	DandA 450DX	DandA 550DX	DandA 650DX	DandA 700DX	DandA 750DX	DandA 1200DX
Operating weight	kg		2,770	3,487	4,099	4,486	5,838	6,710	9,564
	lb		6,107	7,688	9,037	9,890	12,871	14,793	21,085
Required oil flow	l/min		170~221	187~238	204~272	221~306	238~323	255~340	298~383
	g/min		44.91~58.38	49.40~62.87	53.89~71.85	58.38~80.84	62.87~85.33	67.36~89.82	78.72~101.18
Operating pressure	kg/cm <sup>2</sup>		160~190	150~190	150~190	150~190	170~210	170~210	170~210
	psi		2,276~2,702	2,134~2,702	2,134~2,702	2,134~2,702	2,418~2,987	2,418~2,987	2,418~2,987
Number of blow	Power mode	bpm	230~400	230~345	230~330	270~380	220~300	205~285	170~230
	Speed mode	bpm	270~470	270~410	270~500	380~530	290~400	235~420	195~275
Relief valve setting pressure	kg/cm <sup>2</sup>		230	230	210	210	250	250	250
	psi		3,271	3,271	2,987	2,987	3,556	3,556	3,556
Tool diameter	mm		155	165	175	180	200	205	240
	inch		6.10	6.50	6.89	7.09	7.87	8.07	9.45
Suitable carrier	ton		28~42	34~50	40~60	45~80	58~100	60~100	85~140
	lbs		61,729~92,594	74,957~110,231	88,185~132,277	99,208~176,370	127,868~220,462	132,277~220,462	187,393~308,647

\* Above numbers are subject to change without prior notice, only provided for references in combination with carrier hydraulic performance.

\* Above operating weight includes 1 working tool, 2 hoses and 1 mounting bracket with 2 pins that are supplied by the manufacturer only.



## Light material handling breaker

Designed for breaker operating champion in dedicated light material breaking application.

DandA 200C			
Operating weight	kg	1,577	
	lb	3,477	
Required oil flow	l/min	102~132	
	g/min	26.95~34.87	
Operating pressure	kg/cm <sup>2</sup>	140~180	
	psi	1,991~2,560	
Number of blow	Power mode	bpm	300~410
	Speed mode	bpm	360~510
Relief valve setting pressure	kg/cm <sup>2</sup>	210	
	psi	2,987	
Tool diameter	mm	135	
	inch	5.31	
Suitable carrier	ton	18~22	
	lbs	39,683~48,502	

\* Above numbers are subject to change without prior notice, only provided for references in combination with carrier hydraulic performance.

\* Above operating weight includes 1 working tool, 2 hoses and 1 mounting bracket with 2 pins that are supplied by the manufacturer only.

## Backhoe loader breaker



		DandA 40V		DandA 60V		DandA 70DX		DandA 80DX	
Operating weight	kg	325		412		518		600	
	lb	717		908		1,143		1,323	
Required oil flow	l/min	29~60		34~68		38~85		42~85	
	g/min	7.66~15.85		8.98~17.96		10.04~22.45		11.10~22.45	
Operating pressure	kg/cm <sup>2</sup>	110~165		120~165		140~170		140~170	
	psi	1,565~2,347		1,707~2,347		1,991~2,418		1,991~2,418	
Number of blow	Power mode	bpm		bpm		bpm		bpm	
	Speed mode	bpm		bpm		bpm		bpm	
Relief valve setting pressure	kg/cm <sup>2</sup>	175		175		175		175	
	psi	2,489		2,489		2,489		2,489	
Tool diameter	mm	70		75		80		90	
	inch	2.76		2.95		3.15		3.54	
Suitable carrier	ton	3.0~6.5		4.5~8.0		4.5~8.0		6.0~10.0	
	lbs	6,614~14,330		9,921~17,637		9,921~17,637		13,228~22,046	

\* Above numbers are subject to change without prior notice, only provided for references in combination with carrier hydraulic performance.

\* Above operating weight includes 1 working tool, 2 hoses and 1 mounting bracket with 2 pins that are supplied by the manufacturer only.

## Skid steer loader breaker



		DandA 17V		DandA 40V		DandA 60V		DandA 70DX	
Operating weight	kg	270		357		430		542	
	lb	595		787		948		1,195	
Required oil flow	l/min	23~70		35~70		40~80		45~90	
	g/min	6.08~18.49		9.25~18.49		10.57~21.13		11.89~23.78	
Operating pressure	kg/cm <sup>2</sup>	100~190		110~190		120~190		140~190	
	psi	1,422~2,702		1,565~2,702		1,707~2,702		1,991~2,702	
Number of blow	Power mode	bpm		bpm		bpm		bpm	
	Speed mode	bpm		bpm		bpm		bpm	
Relief valve setting pressure**	kg/cm <sup>2</sup>	230		230		230		230	
	psi	3,271		3,271		3,271		3,271	
Tool diameter	mm	57		70		75		80	
	inch	2.24		2.76		2.95		3.15	
Suitable carrier	ton	1.5~4.0		3.0~6.5		4.5~8.0		4.5~8.0	
	lbs	3,307~8,818		6,614~14,330		9,921~17,637		9,921~17,637	

\* Above numbers are subject to change without prior notice, only provided for references in combination with carrier hydraulic performance.

\* Above operating weight includes 1 working tool, 2 hoses and 1 skid bracket that are supplied by the manufacturer only.



Ref. No. Brochure 06 / English / Printed in Seoul 2024.01-0.0



[www.dnabreaker.com](http://www.dnabreaker.com)

Head Office #901, ACE High-end Tower 9th, 233,  
Gasam Digital 1-Ro, Geumcheon-Gu, Seoul, 08501, Korea  
Tel (Rep.) : +82 2 2617 0488 Fax (Rep.) : +82 2 2617 0489



Product designs and/or specifications may be changed at any time without prior notice. All rights reserved.